

SFET



Materials

Stationary - Car, SiC, SSiC, TC
 Rotary - SiC, SSiC, TC
 Elastomer - NBR, EPDM, Viton, Aflas

Working Conditions

Pressure < 21 bar
 Speed < 25 m/s
 Temperature up to 205°C

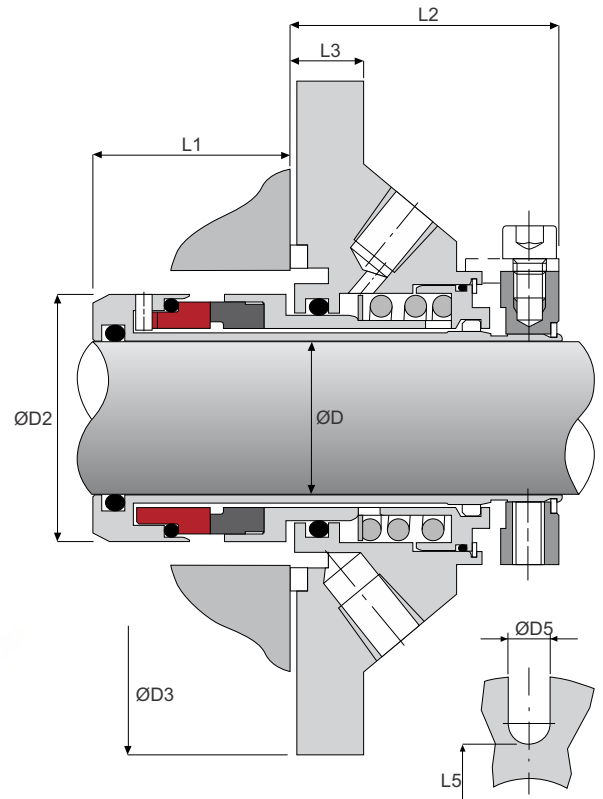

Features:

- Stationary Design
- Monolithic Faces
- Cushioned Faces
- Pressure balanced
- Springs outside the media
- Single spring
- Heavy duty drive

Seal Size ØD	Code	ØD2	ØD3	ØD5	L1	L2	L3	L5	S-Box Bore	
									Min	Max
25	0250	39.7	112	12	36	48.0	12	58.0	41.0	47.5
28	0280	42.7	116	12	36	48.0	12	61.0	44.0	50.5
30	0300	44.2	117	12	36	48.0	12	63.0	46.0	52.5
32	0320	46.2	119	12	36	48.0	12	65.0	48.0	54.5
33	0330	49.2	122	12	36	48.0	12	68.0	51.0	57.5
35	0350	49.2	122	12	36	48.0	12	68.0	51.0	57.5
38	0380	55.2	128	12	38	48.0	12	74.0	57.0	63.5
40	0400	58.2	136	14	38	48.0	12	76.5	60.0	66.5
43	0430	62.2	140	14	38	48.0	12	81.0	63.5	70.0
45	0450	62.2	140	14	38	48.0	12	81.0	63.5	70.0
48	0480	65	145	14	38	50.0	13	84.0	66.8	73.0
50	0500	68.2	150	14	38	50.0	13	87.0	70.0	76.5
53	0530	71.1	155	14	38	50.0	13	91.0	73.0	79.5
55	0550	71.1	155	14	38	50.0	13	91.0	73.0	79.5
60	0600	77.7	165	14	38	50.0	13	98.5	79.4	85.5
65	0650	87.9	190	17.5	44	57.0	13	111.5	90.0	96.5
70	0700	93.7	200	17.5	44	57.0	13	118.5	95.0	101.4
75	0750	99.9	205	17.5	44	57.0	13	125.0	101.6	108.0
80	0800	106.2	210	17.5	44	57.0	13	131.5	108.0	114.5
85	0850	109	240	17.5	46	60.5	13	138.0	111.0	124.0
90	0900	115.5	275	22	46	62.5	16	146.0	117.0	131.0
95	0950	118.5	275	22	46	62.5	16	146.0	120.5	131.0
100	1000	125	280	22	46	62.5	16	152.0	127.0	136.5